

St. Joseph AME Church
804 Fayetteville Street, Durham,
Durham County, North Carolina
Location Map

Southwest Durham Quadrangle, 2022

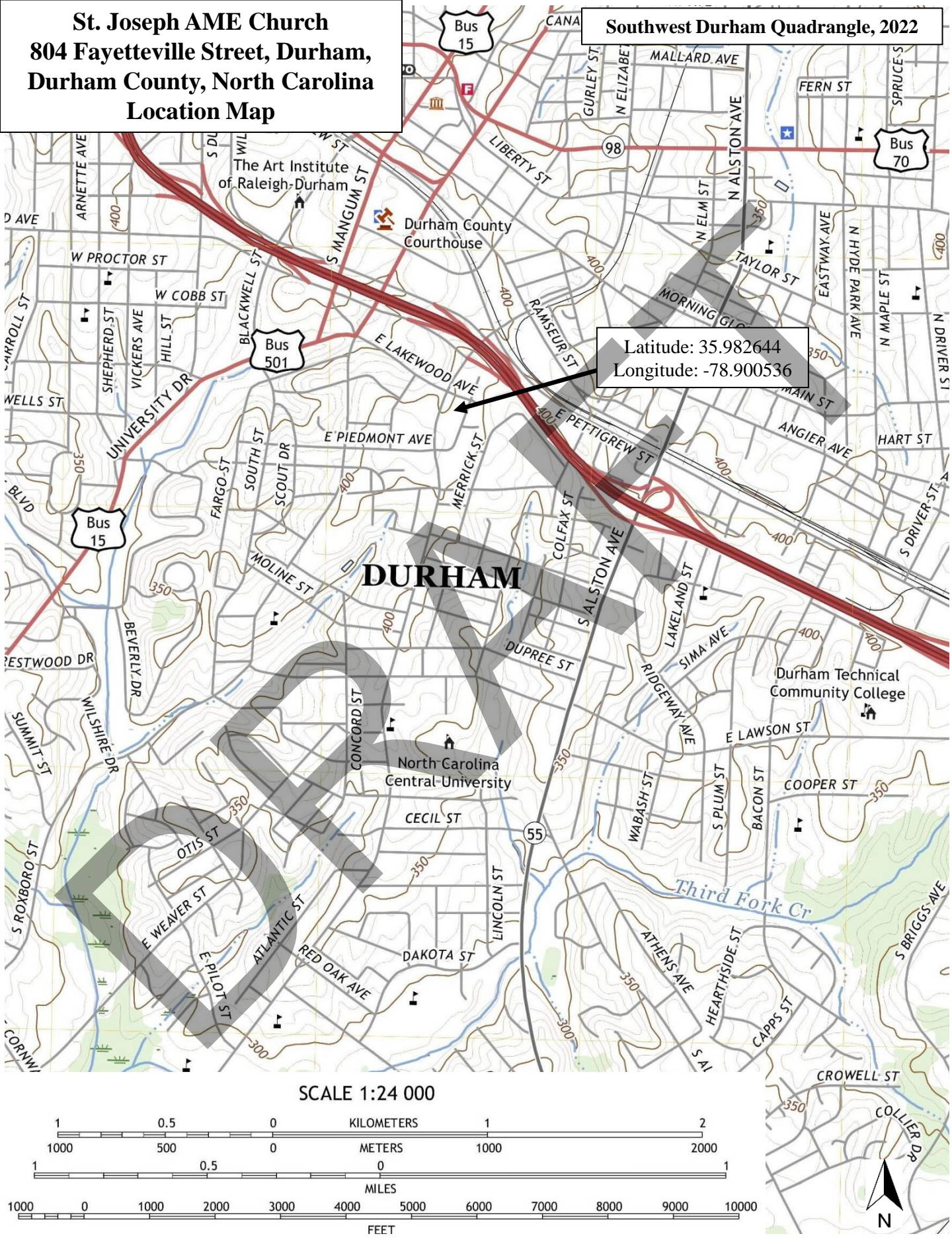

St. Joseph AME Church
804 Fayetteville Street, Durham
Durham County, North Carolina
National Register Boundary Map
and Photograph Key

National Register Boundary
Durham County tax parcel #0 (1.05 acres)

Latitude: 35.985776
Longitude: -78.897838

East
Lakewood
Avenue

Withers
Court

Old
Fayetteville
Street

Fayetteville
Street

6 →

5 ↙

1 ↙

2 ←

3 ↙

4 ↙

1891

1991

1991

1952/1991

1991

1991

40ft



**St. Joseph AME Church
804 Fayetteville Street, Durham
Durham County, North Carolina
Basement Floor Plan and
Photograph Key**

Some room functions have changed since the floor plan was created circa 1989 by DePasquale Thompson Wilson. The dressing rooms and restrooms beneath the sanctuary were not constructed.

photograph views annotated by Heather Fearnbach
Fearnbach History Services, Inc.
January 2024

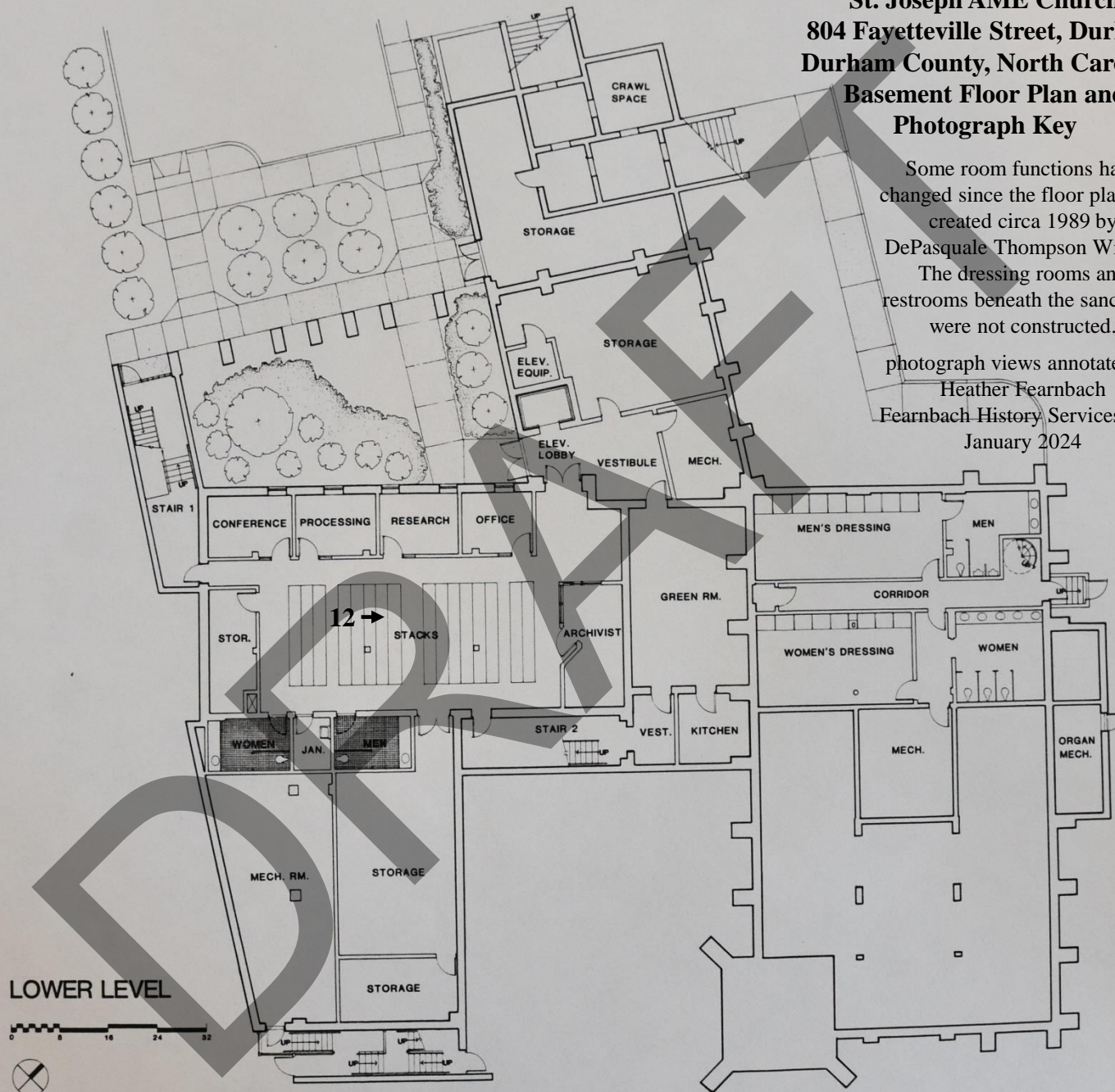

LOWER LEVEL

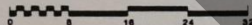

HAYTI HERITAGE CENTER

St. Joseph AME Church
804 Fayetteville Street, Durham, Durham County, North Carolina
First Floor Plan Before Renovation
Exhibit B

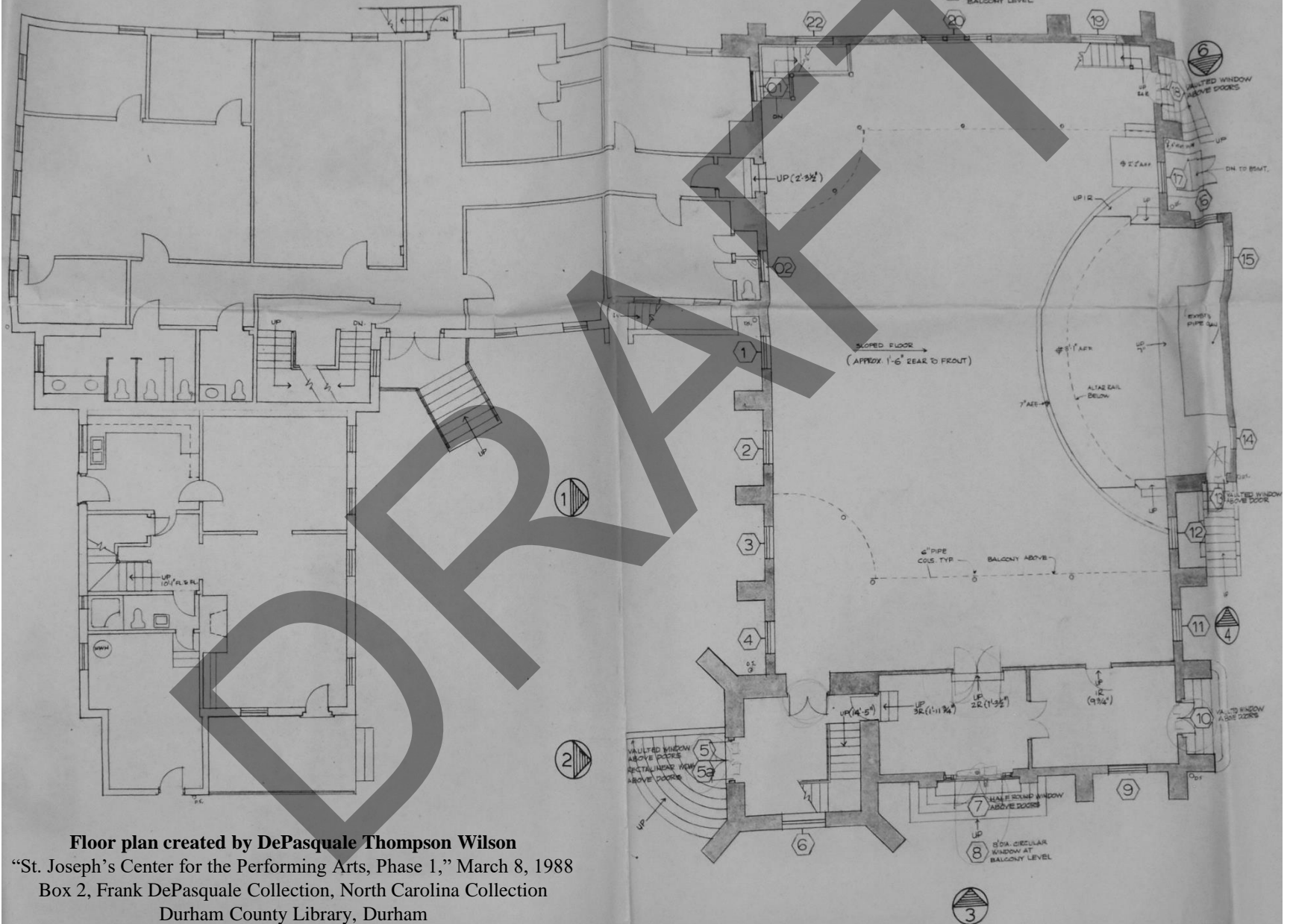

Floor plan created by DePasquale Thompson Wilson
 "St. Joseph's Center for the Performing Arts, Phase 1," March 8, 1988
 Box 2, Frank DePasquale Collection, North Carolina Collection
 Durham County Library, Durham

**St. Joseph AME Church
804 Fayetteville Street, Durham
Durham County, North Carolina
First Floor Plan and Photograph Key**

Floor plan created by DePasquale
Thompson Wilson circa 1989
photograph views annotated by
Heather Fearnbach, Fearnbach History
Services, Inc. / January 2024

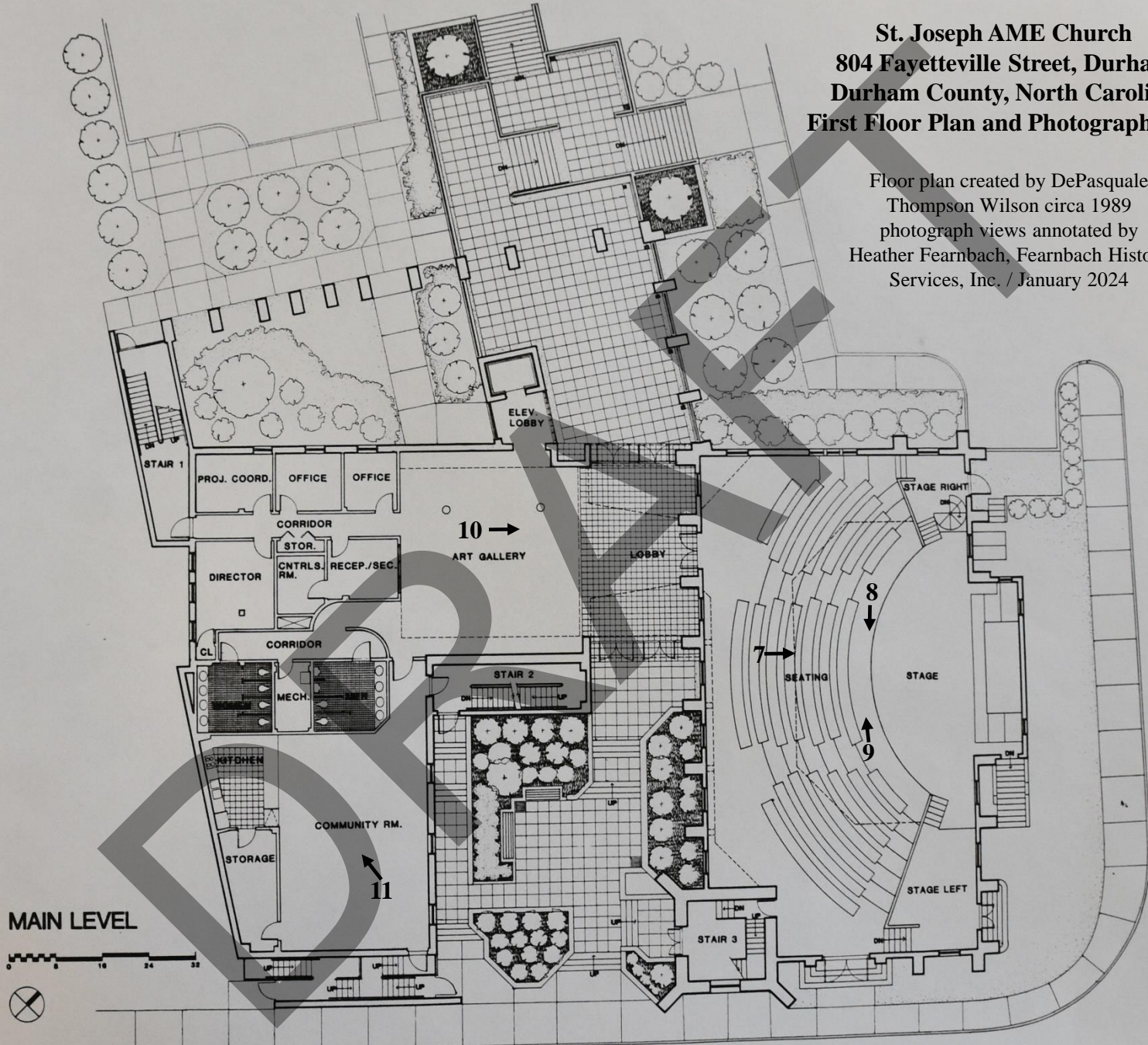

HAYTIHERITAGE CENTER

St. Joseph AME Church
804 Fayetteville Street, Durham
Durham County, North Carolina
Second Floor Plan and Photograph Key

Floor plan created by
DePasquale Thompson Wilson circa 1989
photograph views annotated by Heather Fearnbach
Fearnbach History Services, Inc. / January 2024

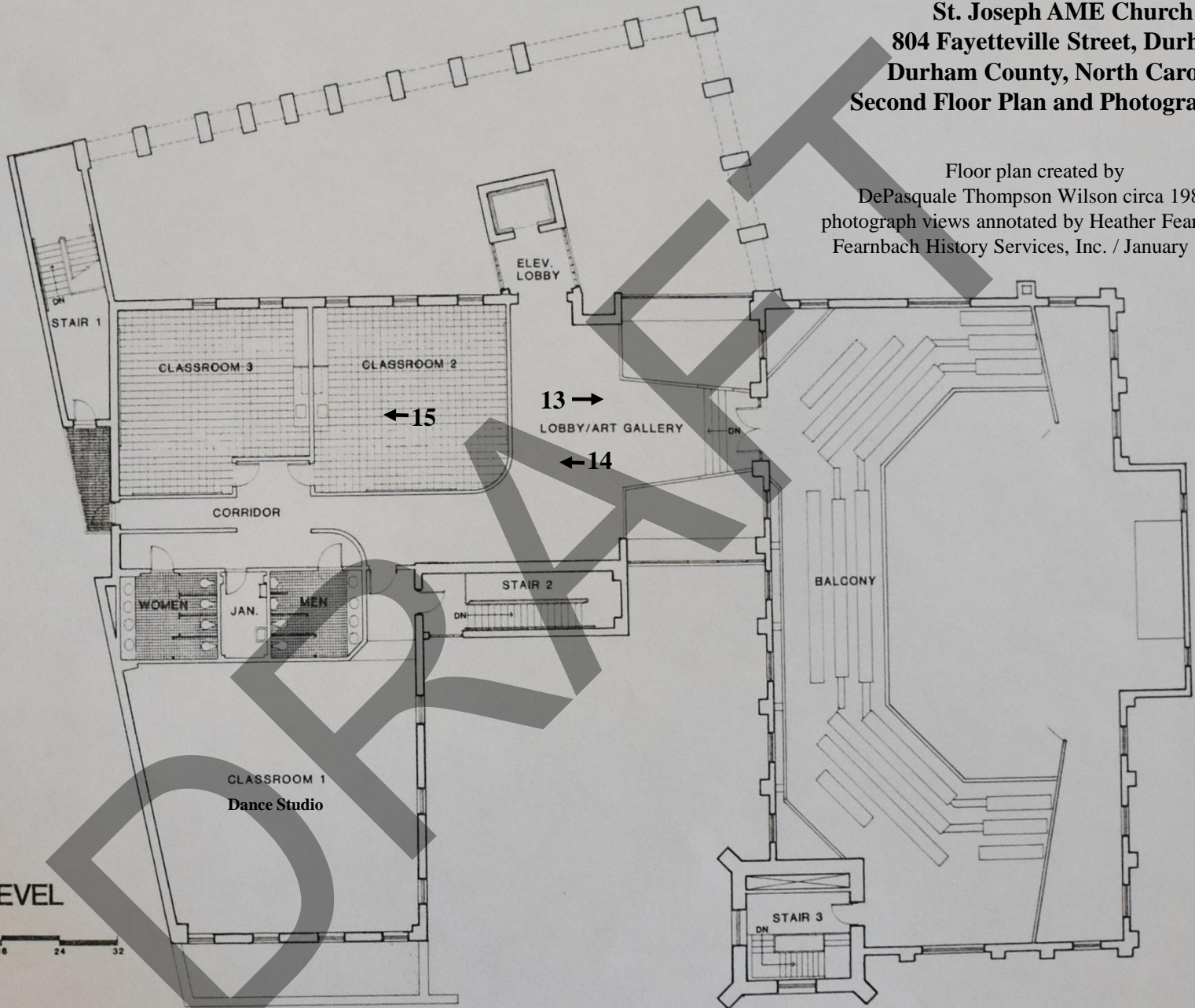

UPPER LEVEL

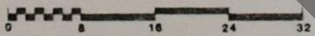

HAYTI HERITAGE CENTER