

Pineburr Hosiery Mill Location Map

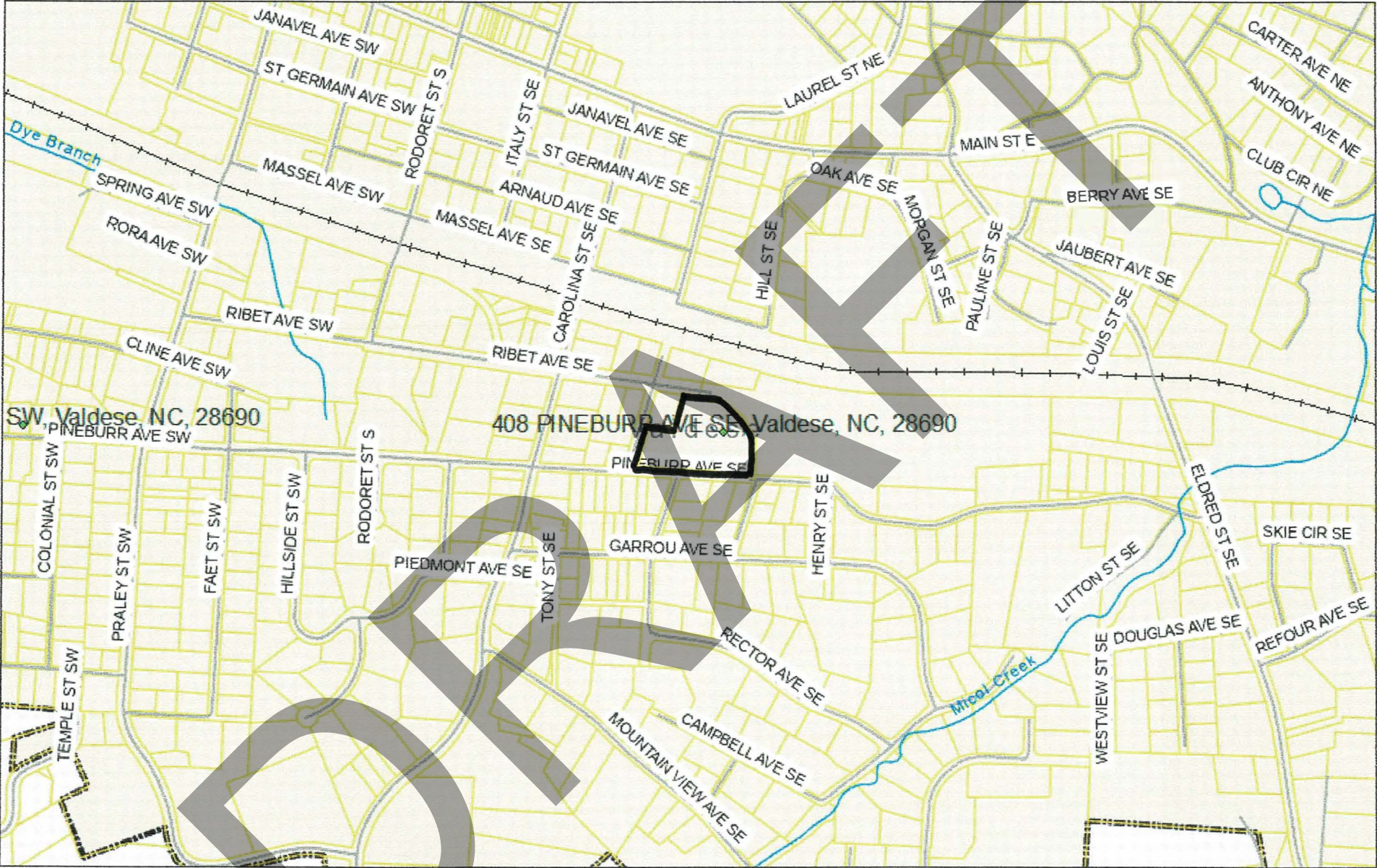

December 9, 2024
Pineburr Hosiery Mill
408 Pineburr Avenue SE
Valdese, NC
Burke County

35.737857 - 81.558776

Map Created by: Subil Argintar
Source: Burke County GIS, Go Maps

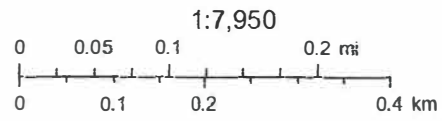

Pineburr Hosiery Mill Boundary Map



December 9, 2024
Pineburr Hosiery Mill
400 Pineburr Avenue SE
Valdese, NC
Burke County

35.737097 -81.558776

HR Boundary —

Map Created by: Sybil Argintar
Source: Burke County GIS, Go Maps

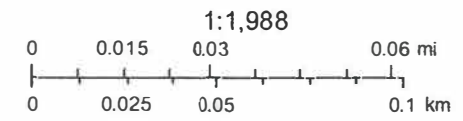

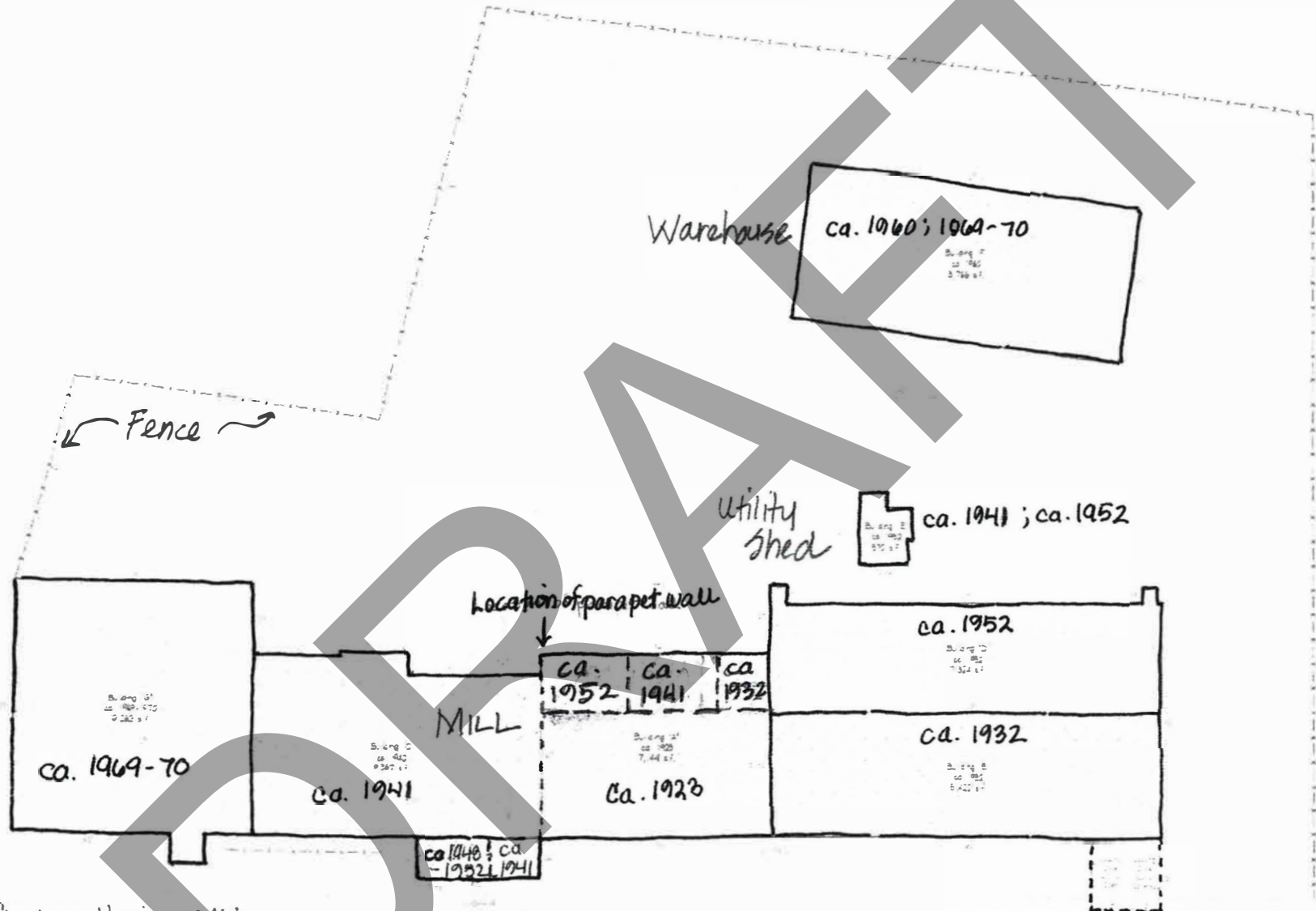

Pineburr Hosiery Mill
 400 Pineburr Ave SE
 Valdese, NC Burke County

OVERALL BUILDING SITE PLAN
 SCALE: 1" = 40'-0"
 120.0 S.F. FOOTPRINT - NEW BUILDING

NORTH

Exhibit A
 Construction Timeline
 and Site Plan

James M. Reiff, Architect
 P.O. Box 514
 Rutherford College, NC 28671
 828-413-2276
 rd@rdarcbox.com



Not a member of the Board
 of the Architects Act
 of the State of North Carolina
 No. 123456789
 State of North Carolina
 Board of Architecture

Existing Drawings For:
Pineburr Hosiery Mill
 400 Pineburr Avenue SE, Valdese, NC 28676

REV. NO. 2023.12

Overall Building
 Site Plan

Date: Nov. 20, 2023
 Revision:

Sheet
 A-1

Pineburr Hosiery Mill
 408 Pineburr Avenue SE
 Valdese, NC Burke County

NORTH

Floor Plan and Photo Key
 Photo/Direction of View

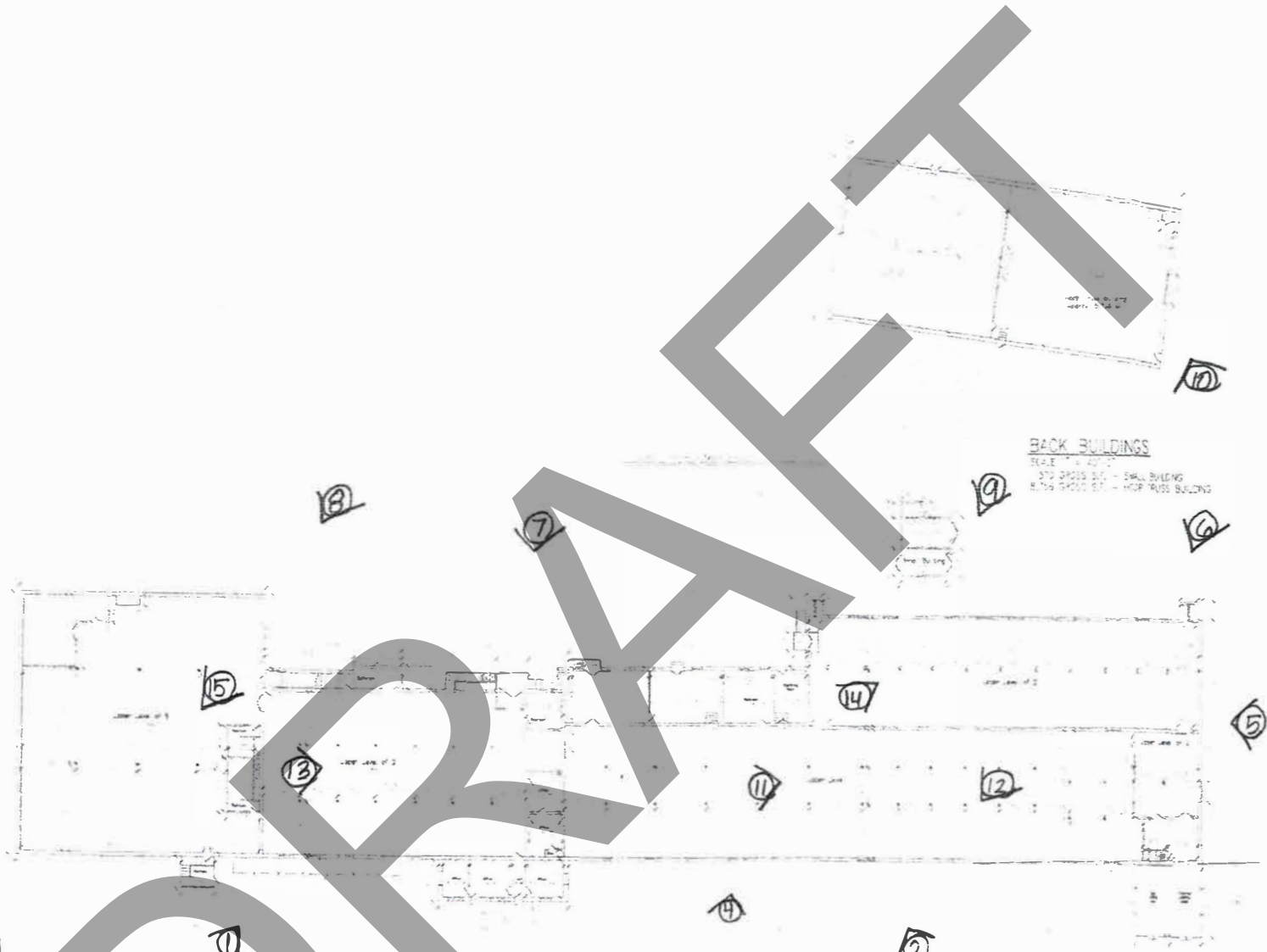

MAIN LEVEL FLOOR PLAN

SCALE 1/8" = 1'-0"

- 48,115 GROSS SF - MAIN LEVEL
- 24,018 GROSS SF - MIDDLE LEVEL
- 10,294 GROSS SF - LOWER LEVEL
- 11,573 GROSS SF - MAIN LEVEL OUTDOOR

BACK BUILDINGS

- SCALE 1/8" = 1'-0"
- 570 GROSS SF - SMALL BUILDING
- 8,756 GROSS SF - HOP TRUSS BUILDING

- 570 GROSS SF - SMALL BUILDING
- 4,768 GROSS SF - HOP TRUSS BUILDING
- 42,415 GROSS SF - MAIN LEVEL - MAIN BUILDING
- 24,018 GROSS SF - MIDDLE LEVEL - MAIN BUILDING
- 10,294 GROSS SF - LOWER LEVEL - MAIN BUILDING
- 28,133 GROSS SF - ALL LEVELS NO OUTDOOR

James M. Reilly, Architect
 P.O. Box 514
 Rubenford College, NC 28671
 828-413-2776
 reillyforarchitect.com



This drawing was prepared by the Architect under the supervision of the Architect. The Architect is not responsible for the accuracy of the information provided by the client.

Existing Drawings For:
Pineburr Hosiery Mill
 408 Pineburr Avenue SE, Valdese, NC 28671

Job No. 202512

Revised
 Date
 Floor Plan

Rev. 20, 2023
 Approved

Sheet
A-2

of
day

Mr.
ilda
mily
Sala,
li-
rou,

Year
J.
and

iss
Pas-

mily
scull.
ilda
Lil-

tee—
Miss
oun-

Miss

EN,
US
ES

(P)—
mous
and

NEW ADDITION VALDESE MILL

VALDESE, July 8.—Foundation work on a sixty by sixty-five foot two-story addition to the Pineburr Mill here was begun today by J. M. Brinkley and Co., builders. The Pineburr Mill is a part of the Waldensian Mills, Inc.

Henry Grill, Jr., vice-president of the Waldensian Mills, said this morning that the new section will be used for knitting and finishing goods, thus making the addition a general step-up in every department of the mill.

The two-story brick addition will adjoin the present West end of the building.

Officials of the growing concerns are Henry F. Garrou, president; Mr. Grill, vice-president; and Albert F. Garrou, secretary and treasurer.